

THE CENTRAL

2203 E UNION STREET, SEATTLE WA 98122



**SPACE AVAILABLE NOW:
2,543 SF DIVISIBLE TO: 1,825 SF AND 718 SF**

Join this diverse, vibrant and rapidly developing corridor of residents and retailers located in the heart of the Central District. This prime location is on the hard corner of 23rd Avenue and East Union — a junction of two main arterials that provide a 360 degree radius of access and influence in one of the fastest growing neighborhoods in the City. The Central, a Lake Union Partners project with 92 apartment homes above retail, sits in the heart of their community development plan. Directly across the street to the north, under construction now, is their East Union project, a new 144 unit building with ground floor retail, and The Stencil is one block away at 24th Avenue and East Union, completed in 2015 with 39 apartment homes and Scott Staples' Feed Co Burgers anchoring the main floor retail. Community-focused retail dominates this area and The Central retailers, Electric Lady and Squirrel Chops, join a line up of well-loved establishments such as Chuck's Hop Shop, the Central Cinema and Union Coffee.

**WestCoast
Commercial**
REALTY

For more information call:
(206) 283-5212
Tiffini Connell

Retail Commercial Specialists



2101 Fourth Avenue, Suite 920
Seattle, WA 98121
www.wccommercialrealty.com

DISCLAIMER: The above information has been secured from sources believed to be reliable, however, no representations are made to its accuracy. Prospective tenants or buyers should consult their professional advisors and conduct their own independent investigation. Site plan and configuration are subject to change. Properties are subject to change in price and/or availability without notice. West Coast Commercial Realty, LLC

Colliers
POWERBROKER
2016 Top Broker Award

Colliers
POWERBROKER
2014 Top Firm Award

CBA
COMMERCIAL BROKERS
ASSOCIATION

ICSC
International Council of Shopping Centers

THE CENTRAL

DEMOGRAPHICS	1-Mile	2-Mile	3-Mile
Average HH Income	\$92,936	\$95,924	\$101,529
Residents	48,127	125,736	185,312
Employees	29,347	230,247	323,196

2203 E UNION STREET, SEATTLE WA 98122

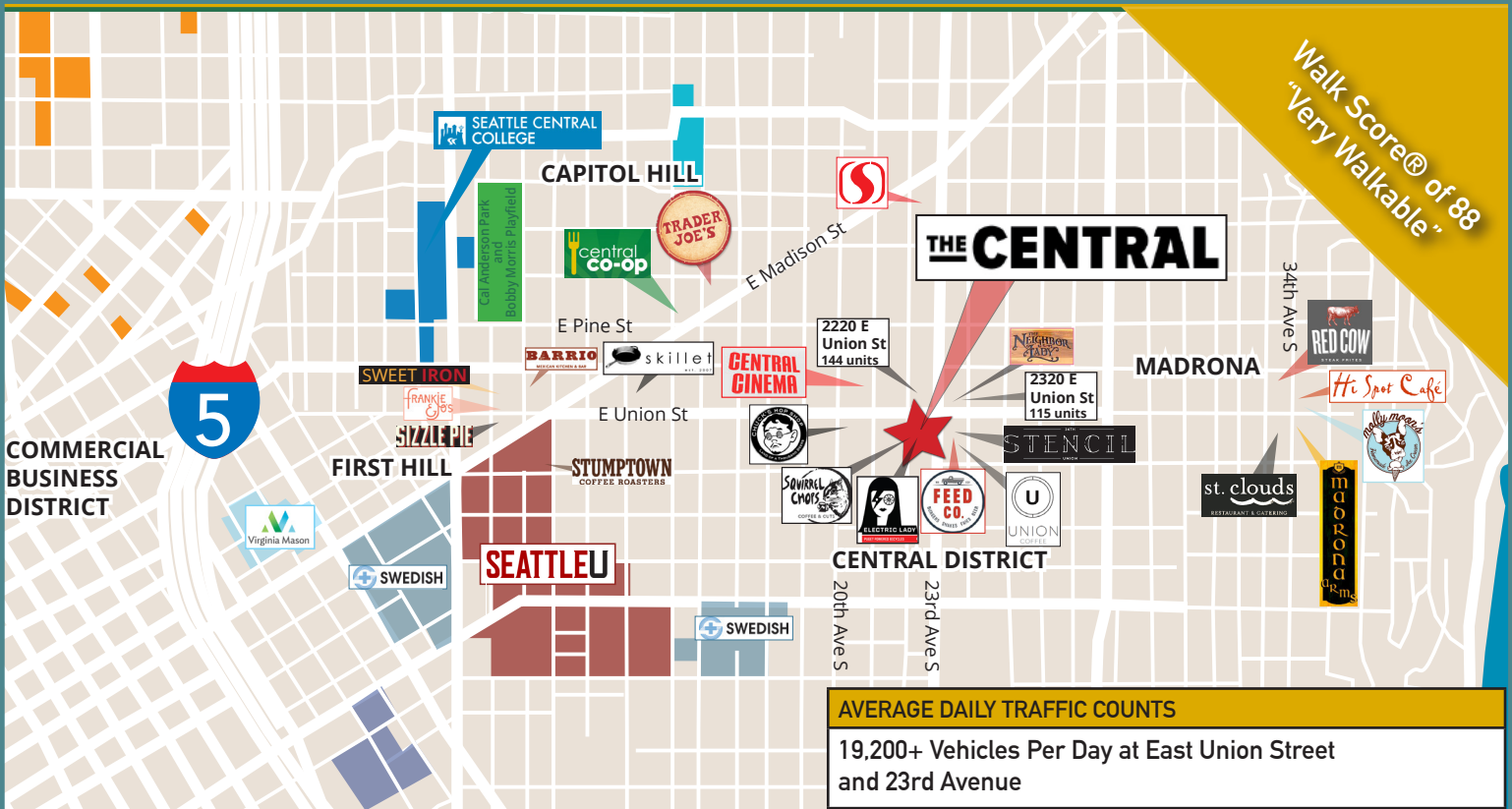

Bridging Capitol Hill and the Central District to Madrona!



WestCoast
Commercial
REALTY

For more information call:
(206) 283-5212
Tiffini Connell

Retail Commercial Specialists



2101 Fourth Avenue, Suite 920
Seattle, WA 98121
www.wccommercialrealty.com

DISCLAIMER: The above information has been secured from sources believed to be reliable, however, no representations are made to its accuracy. Prospective tenants or buyers should consult their professional advisors and conduct their own independent investigation. Site plan and configuration are subject to change. Properties are subject to change in price and/or availability without notice. West Coast Commercial Realty, LLC

Collier
POWERBROKER
2016 Top Broker Award

Collier
POWERBROKER
2014 Top Firm Award

CBA
COMMERCIAL BROKERS
ASSOCIATION

ICSC
International Council of Shopping Centers

THE CENTRAL

2203 E UNION STREET, SEATTLE WA 98122

**2,543 SF Divisible to:
1,825 SF and 718 SF**

**End cap space with large windows,
a roll-up garage-style door,
outdoor dining opportunities with
extra-wide sidewalks and
Tall, 12'6" ceilings.**



23rd Avenue

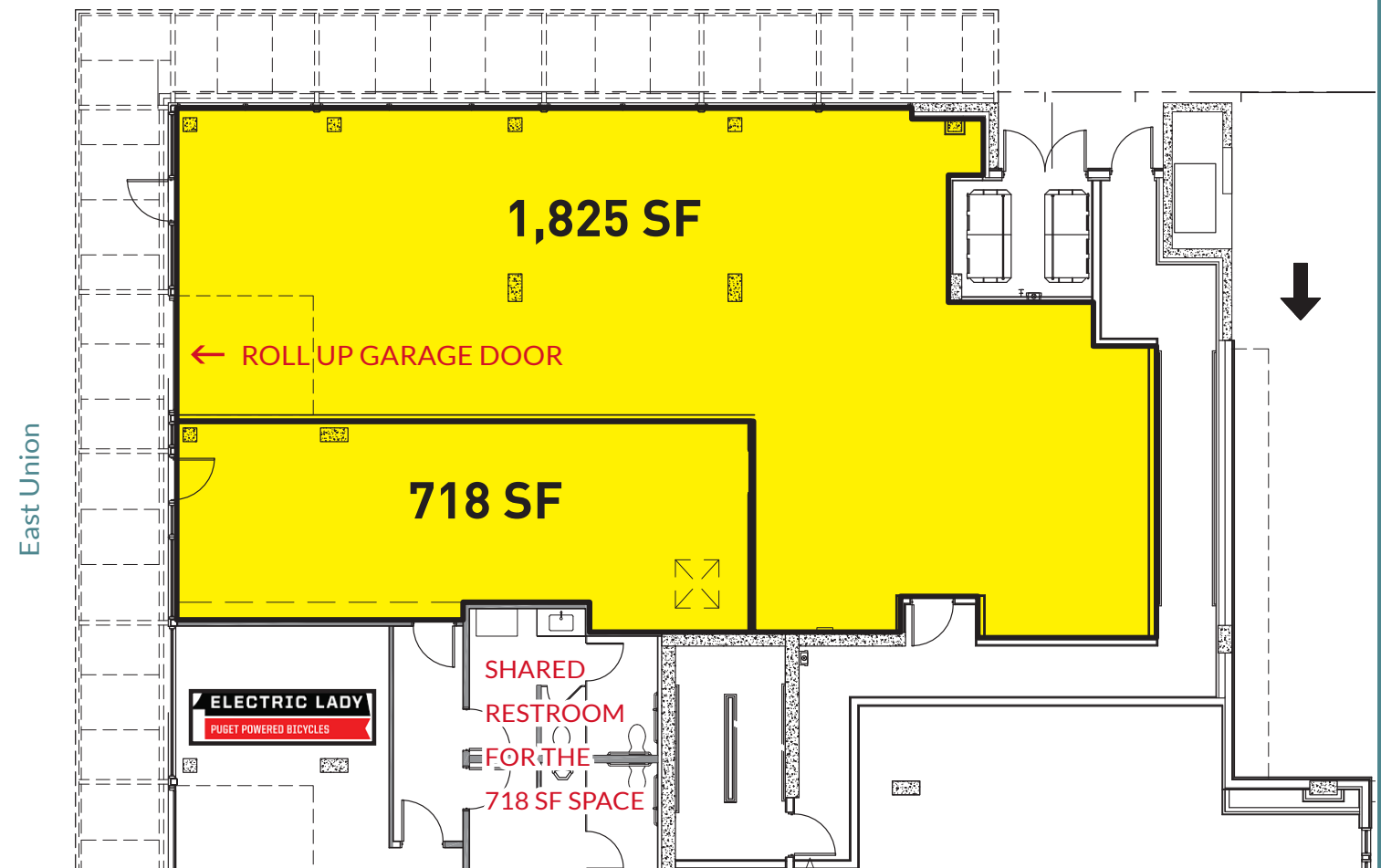

**WestCoast
Commercial**
REALTY

For more information call:
(206) 283-5212
Tiffini Connell

Retail Commercial Specialists

2101 Fourth Avenue, Suite 920
Seattle, WA 98121
www.wccommercialrealty.com



DISCLAIMER: The above information has been secured from sources believed to be reliable, however, no representations are made to its accuracy. Prospective tenants or buyers should consult their professional advisors and conduct their own independent investigation. Site plan and configuration are subject to change. Properties are subject to change in price and/or availability without notice. West Coast Commercial Realty, LLC

Colliers
POWER BROKER
2016 Top Broker Award

Colliers
POWER BROKER
2014 Top Firm Award

CBA
COMMERCIAL BROKERS
ASSOCIATION

ICSC
International Council of Shopping Centers